

# PELLE

Product Guide

## CONTENTS

### ORIGINAL BUBBLE CHANDELIER

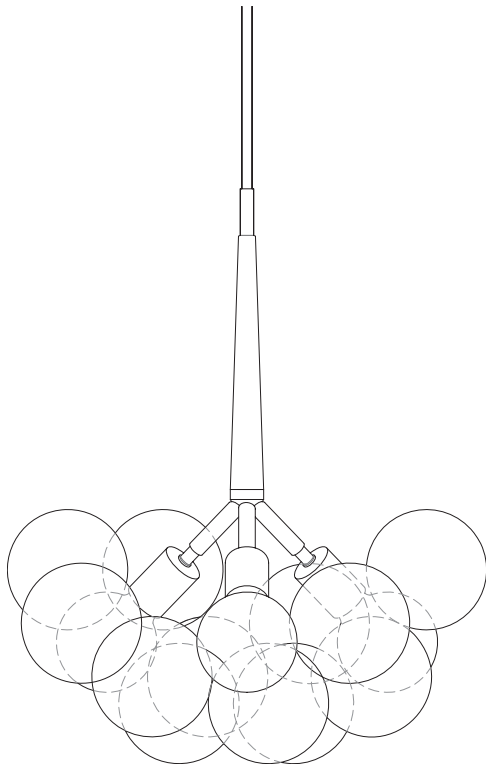

### LAMPING

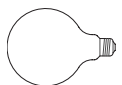

3 X G30 CLEAR INCANDESCENT BULBS  
40W / 60W

### HARDWARE



A CROSS BAR / GROUND SCREW

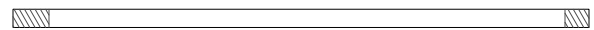

B PIPE

Depending on length, pipe will be inside fixture's box or shipped separately in a cardboard tube.

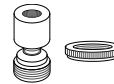

C HANG STRAIGHT / RING



D THREADED NIPPLE

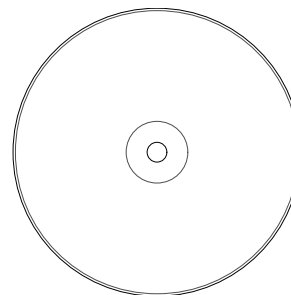

E CANOPY



F HEX NUTS (2)



G BUSHING



H STRAIN RELIEF

### INSTALLATION NOTE

This product must be installed in accordance with the applicable installation code by a person familiar with the construction and operation of the product and the hazards involved.

## INSTALLATION

- 1 When handling fixture, hold at main stem. **Leave bubble wrap pouches on glass globes and protective foam on fixture until installation is complete.**
- 2 Install cross bar (A) into junction box.
- 3 With fixture in box, feed lamp cord through pipe (B)\*. Orient pipe so end with .5" of threading threads into top of fixture. Thread pipe into top of fixture. Avoid any twisting or turning of lamp cord.
- 4 Thread hang straight (C) on to top end of pipe. Thread nipple (D) into hang straight and carefully slide threaded ring of hang straight and canopy (E) down pipe.
- 5 Raise fixture and slide nipple through center hole of cross bar. Secure fixture with two hex nuts (F).
- 6 Install bushing (G) and strain relief (H).
- 7 Make necessary electrical connections in junction box. Connect white (neutral) and black (hot) leads accordingly. Connect grounding wire (bare copper wire) to cross bar. Once connections have been made and tested, raise canopy and ring. Tighten canopy against ceiling.
- 8 **Remove bubble wrap bags before turning on fixture to avoid melting of plastic.** Bags are secured with staples. Remove carefully to avoid scratching fixture's surfaces. Begin with top layer of globes and work towards bottom layers. Avoid knocking glass globes into each other.
- 9 When removing bubble bags pay close attention to numbered stickers. Consult diagram at end of document for correct placement.
- 10 You are done. Enjoy!

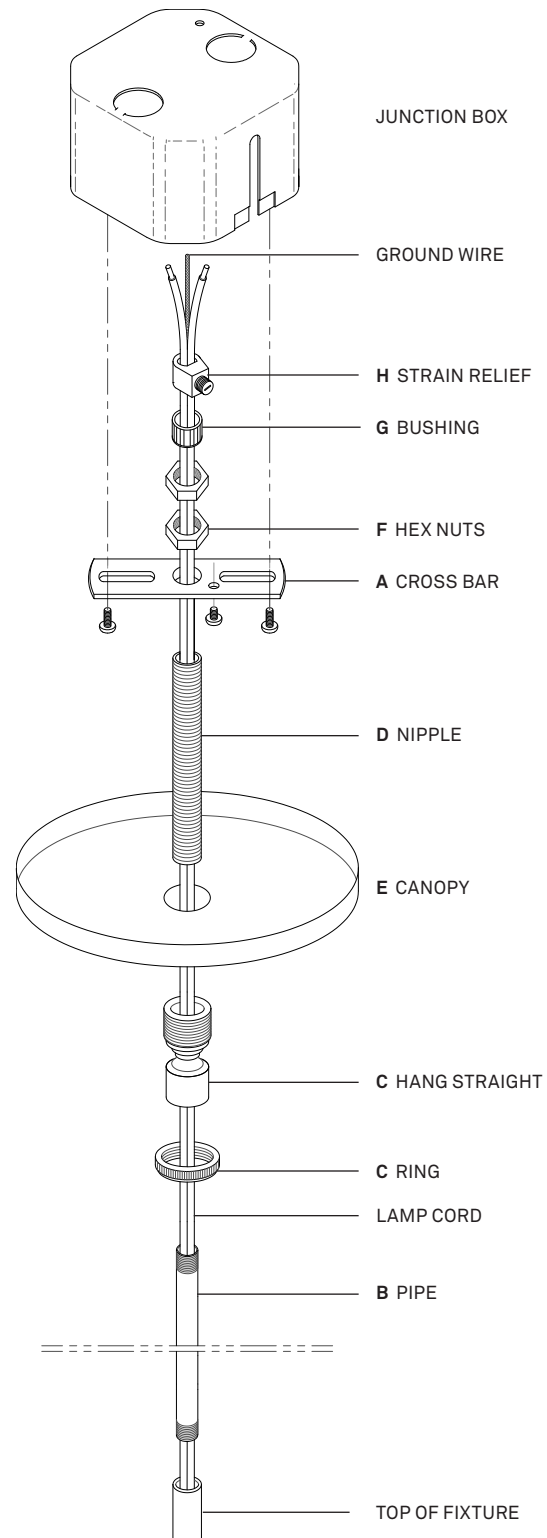

\*If pipe is in 2 parts, thread together as shown. Apply Loctite inside joint. Wait 5 minutes to dry.

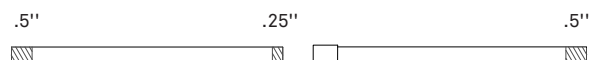

## ARRANGEMENT

Use the diagram to ensure your bubble chandelier has been installed with the correct geometry.

Take care that no strings are crossed and that globes in each level are hanging evenly.

1 - Lowest level

4 - Highest level

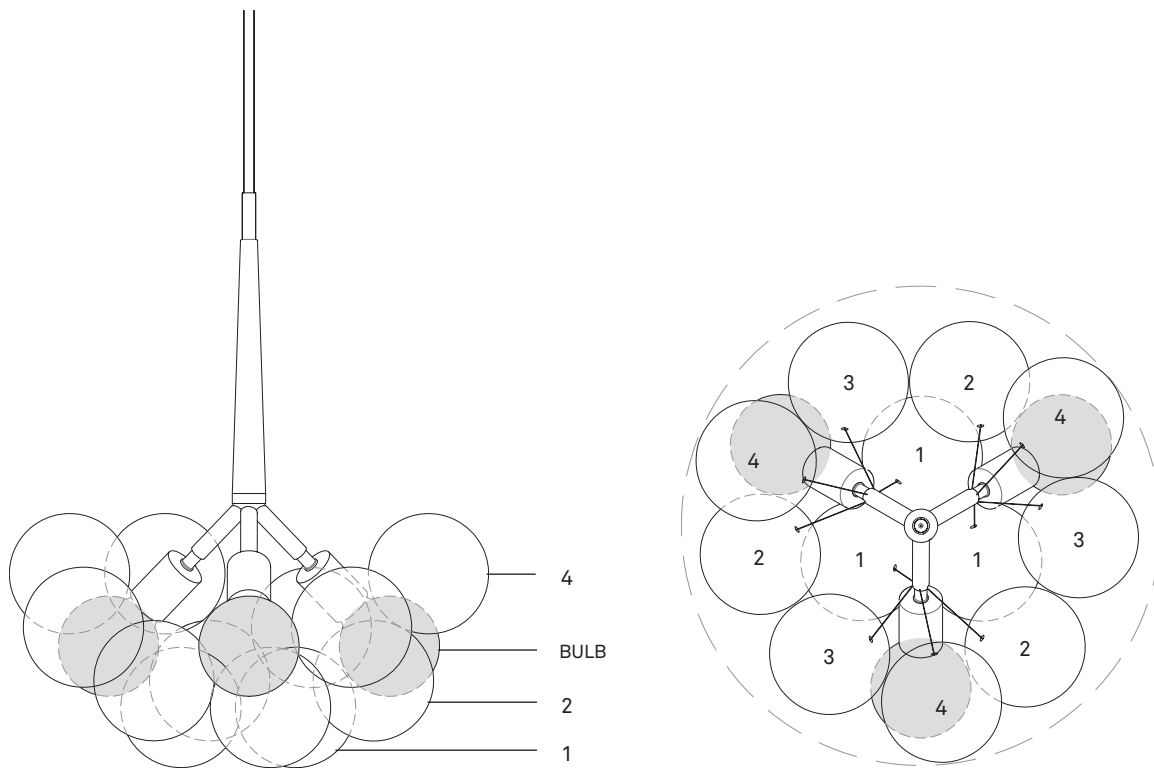

## CHANDELIER CARE

### ON CLEANING

Regular cleaning is essential to prevent dust from building up on the fixture. We recommend wearing the included cotton gloves when cleaning and handling the glass globes.

First, make sure that the chandelier is switched off and cool. For general everyday cleaning, use a soft antistatic dust brush or similar. While dusting keep in mind that the glass globes shouldn't knock against one another.

For cleaning stubborn layers of dust, use a gentle solvent free cleanser with paper towels or a micro fiber cloth. Wipe glass globes gently.

Avoid rotating your chandelier. When cleaning, work in sections and walk or move a ladder around your light fixture.

### GENERAL NOTE

The suspension canopy systems should not be exposed to water or wind, or be allowed to oscillate continuously in any circumstance. Avoid placing fixtures close to HVAC vents or in chemical-laden environments such as indoor swimming pools.

### REPLACEMENTS

Replacement light bulbs are available directly from our online shop. Glass globes can be obtained by emailing the studio.

### WARRANTY

PELLE warrants its products to be free of defects in workmanship under normal use and service for a period of one year from date of purchase. PELLE reserves the right to inspect the damaged product before having any obligation under this limited warranty. All costs of shipping for inspection are the sole responsibility of the purchaser. PELLE, at it's option, shall repair or replace the defective unit covered by this warranty. PELLE is not responsible for damages caused by improper installation, maintenance or operation. Removing warning labels from the fixture or any other modification to the fixture not performed by manufacturer voids the warranty. Our warranty extends to products purchased only by the original purchaser.