

## CONTENTS

### LARGE BUBBLE CHANDELIER

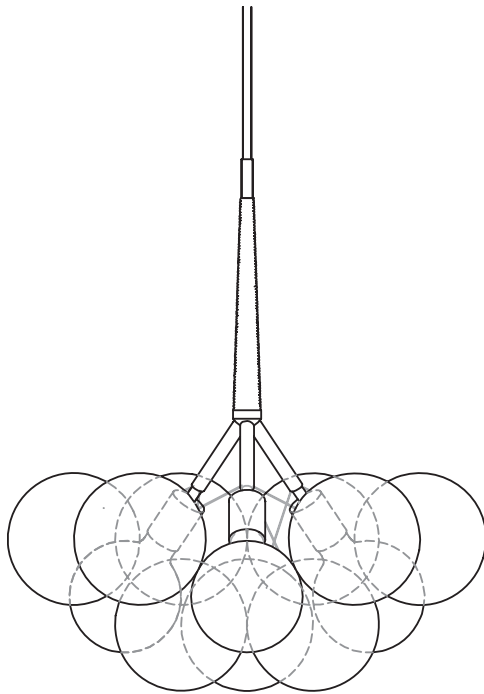
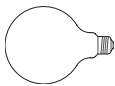
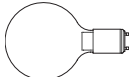

### LAMPING

-  3 X G40 CLEAR INCANDESCENT BULBS  
40W / 60W
-  3 X LED 2-PIN BULBS  
95 CRI - 2700K - 500 LUMENS

### HARDWARE



A CROSS BAR / GROUND SCREW

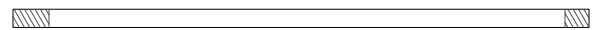

B PIPE

Depending on length, pipe will be inside fixture's box or shipped separately in a cardboard tube.

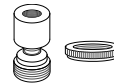

C HANG STRAIGHT / RING



D THREADED NIPPLE

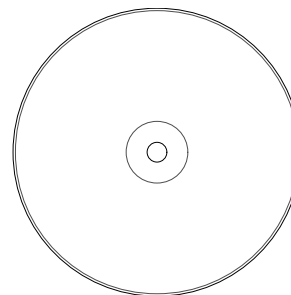

E CANOPY



F HEX NUTS (2)



G BUSHING



H STRAIN RELIEF

### INSTALLATION NOTE

This product must be installed in accordance with the applicable installation code by a person familiar with the construction and operation of the product and the hazards involved.

## ARRANGEMENT

Use the diagram to ensure your bubble chandelier has been installed with the correct geometry.

Take care that no strings are crossed and that globes in each level are hanging evenly.

1 - Lowest level

2 - Highest level

